



Arga™ 6934 Freestanding Swirlpool™ Bathtub

Letter	Description	Swirlpool™
-	Drain Location	Center Drain
-	Equipment Location	Left Side
-	Cutout Template	--
-	Total Weight	830 lbs (376 kg)
-	Floor Loading	51 lb/ft ² (249 kg/m ²)
-	Operating Gallons (Min./Max.)	34/53 Gal (129/200 L)
-	Product Weight	116 lbs (53 kg)
-	Soaking Depth	13.75" (350 mm)
L	Outer Length	69" (1753 mm)
W	Outer Width	34" (864 mm)
H	Overall Height	22" (559 mm)
A	Overflow Height	13.75" (350 mm)
B	Long Edge to Drain Center	34.5" (8576 mm)
C	Short Edge to Drain Center	16.75" (425 mm)
D	Drain Shoe Length	--
E	Flange Height	--
F	Deck Width*	4.75" (121 mm)
G	Service Access Dimensions	No Service Access
I	Floor Cutout for Drain	4" x 4" (102 mm x 102 mm)
J	Interior Dimensions Bottom of Bath (L x W)	43" x 19" (1092 mm x 483 mm)
K	Interior Dimensions Top of Bath (L x W)	59" x 25.25" (1498 mm x 641 mm)
L2	Interior Depth - Drain End	16.5" (419 mm)
M	Backrest Angle	30°
N	Footprint (L x W)	63.75" x 30" (1619 mm x 762 mm)

NOTE

The overall dimensions are nominal with a tolerance of +0 and -.25" (6 mm).

Electrical Specification (requires a separate, dedicated GFCI protected circuit):

Motor/Pump: 120V 15A 60Hz

KEY DIMENSIONS

*Deck width reflects only area indicated on detail.

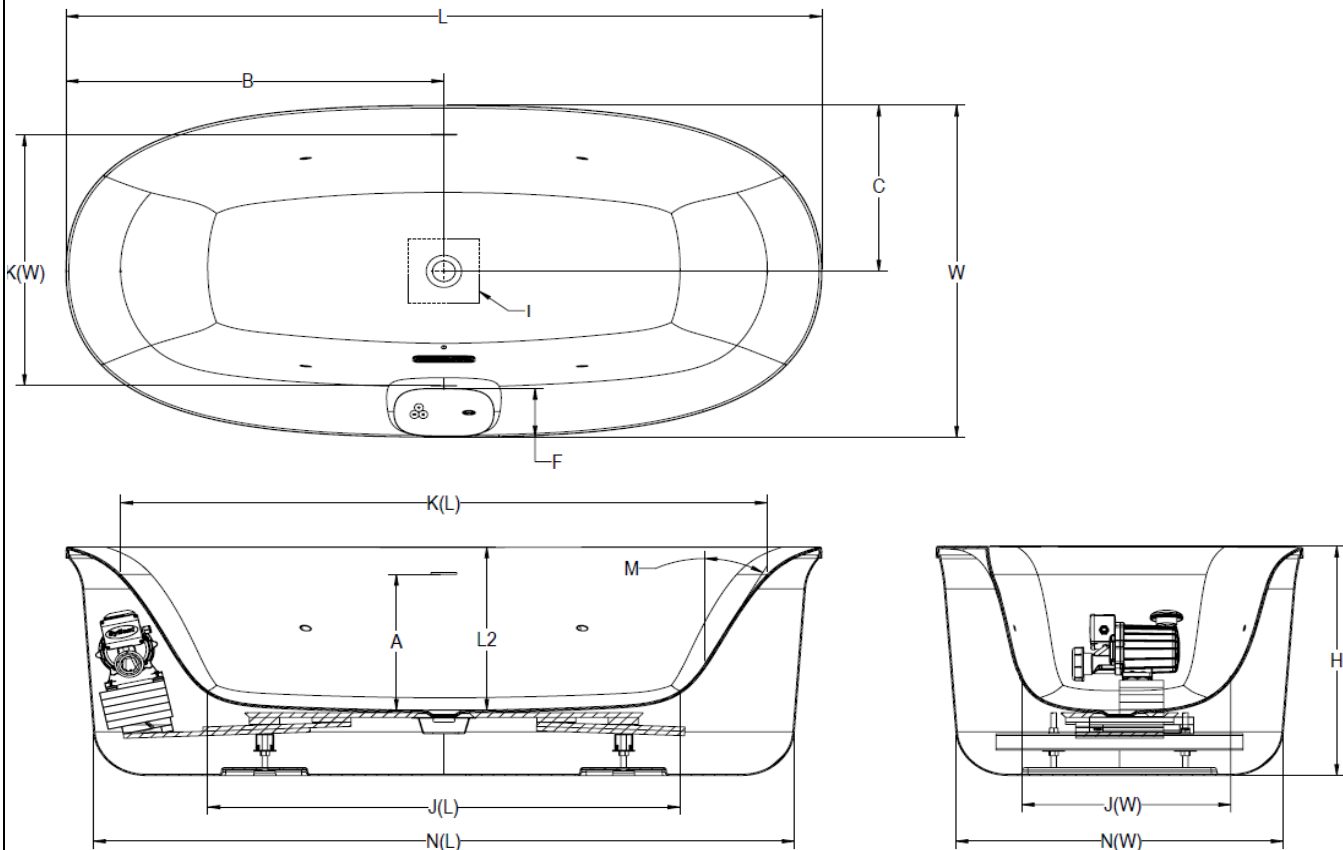

©2019 Jacuzzi Luxury Bath • For additional information, call Customer Service 800-288-4002 • www.jacuzzi.com/baths
 Refer to installation instructions included with fixture before beginning installation. Please confirm product availability and specifications before commencing with any installation work.

PRODUCT SPECIFICATIONS AND AVAILABILITY ARE SUBJECT TO CHANGE WITHOUT NOTICE