

**Stretto™ Freestanding Bathtub**

| Letter | Description                                   | Soaking  |  |
|--------|---|--|--|
|        |   | 5930   | 6732   |
| -      | Drain Location                                | Universal                                      |  |
| -      | Equipment Location                            | --   |  |
| -      | Cutout Template                               | --   |  |
| -      | Total Weight                                  | 893 lbs (405 kg)                               | 1044 lbs (474 kg)                              |
| -      | Floor Loading                                 | 73 lb/ft <sup>2</sup> (356 kg/m <sup>2</sup> ) | 71 lb/ft <sup>2</sup> (347 kg/m <sup>2</sup> ) |
| -      | Operating Gallons                             | 67 Gal (254 L)                                 | 83 Gal (314 L)                                 |
| -      | Product Weight                                | 84 lbs (38 kg)                                 | 97 lbs (44 kg)                                 |
| -      | Soaking Depth                                 | 15.7" (399 mm)                                 | 15.7" (399 mm)                                 |
| L      | Outer Length                                  | 59.2" (1504 mm)                                | 67.0" (1702 mm)                                |
| W      | Outer Width                                   | 29.7" (754 mm)                                 | 31.5" (800 mm)                                 |
| H      | Overall Height                                | 23.6" (599 mm)                                 | 23.6" (599 mm)                                 |
| A      | Overflow Height                               | 16.1" (409 mm)                                 | 16.1" (409 mm)                                 |
| B      | Long Edge to Drain Center                     | 11.6" (295 mm)                                 | 13.3" (338 mm)                                 |
| C      | Short Edge to Drain Center                    | 14.8" (376 mm)                                 | 15.8" (401 mm)                                 |
| D      | Drain Shoe Length                             | --   |  |
| E      | Flange Height                                 | --   |  |
| F      | Deck Width*                                   | 1.4" (36 mm)                                   | 1.5" (38 mm)                                   |
| G      | Service Access Dimensions                     | No Service Access                              |  |
| I      | Floor Cutout for Drain                        | 4" x 4" (102 mm x 102 mm)                      |  |
| J      | Interior Dimensions<br>Bottom of Bath (L x W) | 46.5" x 20.4" (1181 mm x 518 mm)               | 50.2" x 22.1" (1275 mm x 561 mm)               |
| K      | Interior Dimensions<br>Top of Bath (L x W)    | 56.4" x 26.9" (1433 mm x 683 mm)               | 64.0" x 28.5" (1626 mm x 724 mm)               |
| L2     | Interior Depth - Drain End                    | 18.6" (472 mm)                                 | 18.6" (472 mm)                                 |
| M      | Backrest Angle                                | 11.8°  | 12.0°  |
| N      | Footprint (L x W)                             | 44.8" x 19.7" (1138 mm x 500 mm)               | 50.5" x 21.4" (1283 mm x 544 mm)               |

**NOTE**

The overall dimensions are nominal with a tolerance of +0 and -.25" (6 mm).

CAUTION: The integral overflow cover is not removable. The warranty will be voided if attempted.

**KEY DIMENSIONS**

\*Deck width reflects only area indicated on detail.

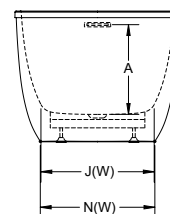
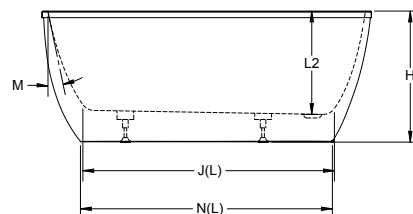
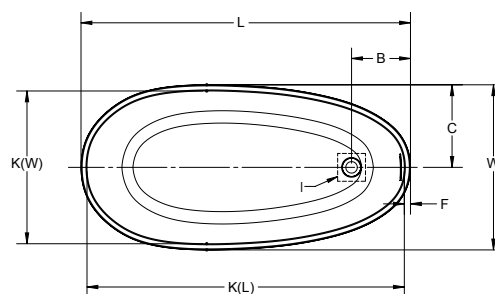

©2018 Jacuzzi Luxury Bath • For additional information, call Customer Service 800-288-4002 • [www.jacuzzi.com/baths](http://www.jacuzzi.com/baths)  
Refer to installation instructions included with fixture before beginning installation. Please confirm product availability and specifications before commencing with any installation work.

PRODUCT SPECIFICATIONS AND AVAILABILITY ARE SUBJECT TO CHANGE WITHOUT NOTICE