

Allusion 6636 Pure Air Bath



Product Codes beginning with: ALL6636ACR

Also applies to products sold under part numbers: LA10, LA30

TECHNICAL SPECIFICATIONS

	English	Metric
Outer Dimensions	66" L x 36" W x 26" H	1676 mm L x 914 mm W x 660 mm H
Interior Dimensions (bottom of bath) L x W (Mid) x W (End)	41 3/8" L x 19 1/2" W x 21 7/8" W	1052 mm L x 495 mm W x 556 mm W
Drain/Blower Configuration	Center drain/Right end blower	Center drain/Right end blower
Bath Weight (empty)	135 lbs	61 kg
Total Weight/Floor Loading	1,010 lbs 61.2 lbs/ft ²	458 kg 298.7 kg/m ²
Operating Gallonage (min-max)	56 (min) 75 (max) U.S. Gals	212 (min) 284 (max) L
Electrical Specifications	Each component requires a separate, dedicated GCFI protected circuit(s)	
Blower		120V 15A 60HZ
Chromatherapy (if selected)		120V 15A 60HZ

FEATURES, UPGRADES & ACCESSORIES

Material Type: High-Gloss Acrylic

Install Type: Drop-in

Available Colors: White (W), Almond (A), Oyster (Y), Black (B)

Cut-out Template: BY20000

Standard (Included) Features:

Chromatherapy lighting, 800w blower,
bottom and side air channels

Available Control Systems:

J4 Luxury Control Panel (standard)

J5 Luxury LCD Control Panel

Available Upgrades:

900w blower (with J5 LCD Control Panel)

Available Accessories:

DA34 Rotary Drain Kit PVC (specify metal finish)

HP55 Rotary Drain Kit (specify metal finish)

827: Chrome, 826: Brushed Nickel, 845: Oil Rubbed Bronze

EK91 21" Straight Pillow (specify color) 959: White, 958: Almond,

969: Oyster

GQ88 Light Chromatherapy Add-on Kit

KEY DIMENSIONS

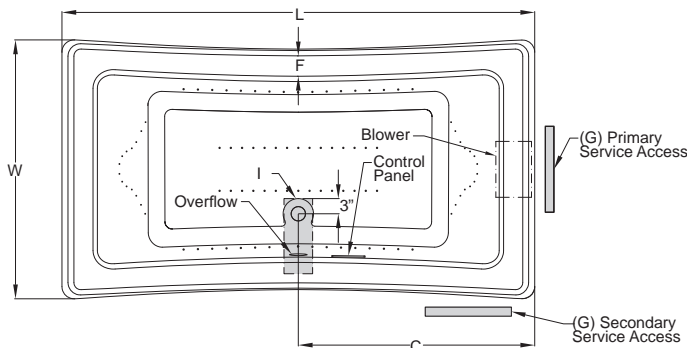

*Deck width reflects only area indicated on detail.

Letter	Description	English	Metric
L	Outer Length	66"	1676 mm
W	Outer Width	36"	914 mm
H	Overall Height	26"	660 mm
A	Overflow Height	17 3/8"	441 mm
B	Long Edge to Drain Center	11 15/16"	302 mm
C	Short Edge to Drain Center	33"	838 mm
D	Drain Shoe Length	6"	152 mm
E	Deck Height	4"	102 mm
F	Deck Width*	3 7/8"	97 mm
G	Service Access Dimensions	12" H x 18" L	305 mm x 457 mm
I	Floor Cut-out for Drain	10 1/2" x 4"	267 mm x 102 mm

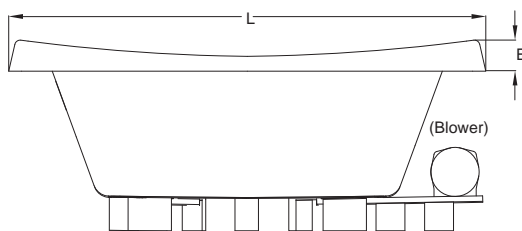

Side View

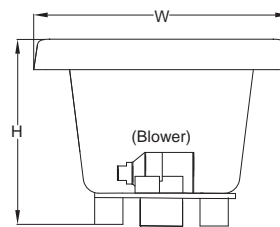

End View

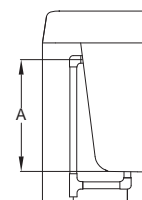

Drain/Overflow

NOTE: Graphics May Not be to Scale

© 2010 Jacuzzi Luxury Bath • For additional information call Customer Service 800-288-4002 • www.jacuzzi.com/technicalspecs

Refer to installation instructions included with fixture before beginning installation. Please confirm product availability and specifications before commencing with any installation work.

PRODUCT SPECIFICATIONS AND AVAILABILITY ARE SUBJECT TO CHANGE WITHOUT NOTICE.

HC47000 REL 02/10